

## Model 465

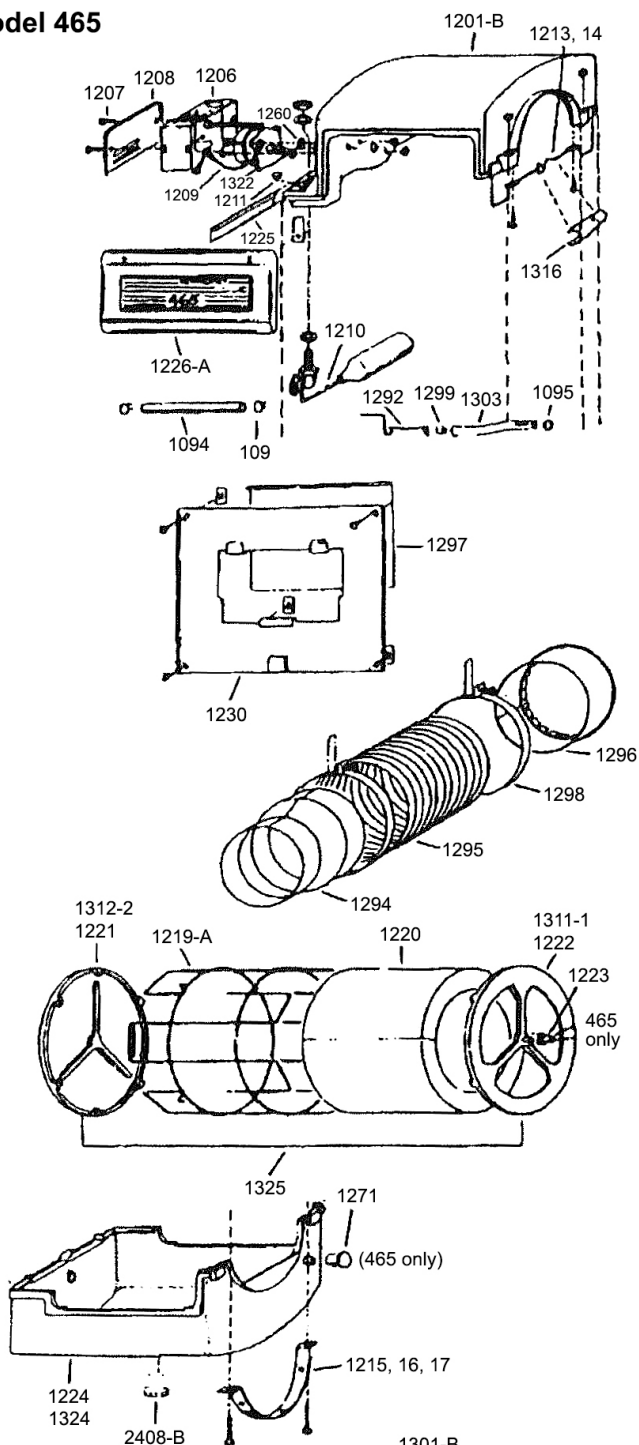

## Model 470 (Obsolete Model)

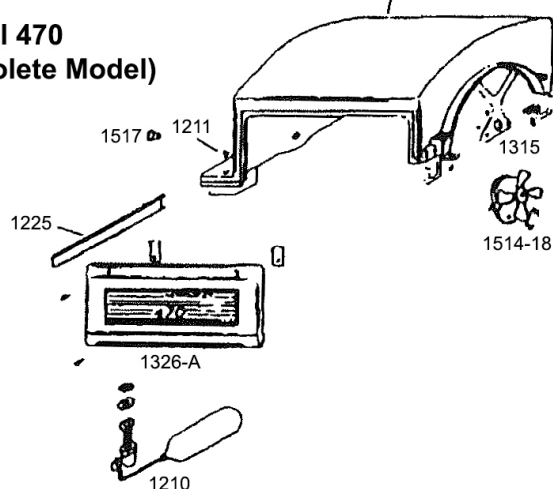

# HERRMIDIFIER MODEL 470 HUMIDIFIER PARTS LIST

Model 470	DESCRIPTION
	Top
	Motor 24V 50-60Hz (replaces 1414A)
	Motor 115V 50-60Hz (replaces 1414A-1)
	Motor 220V 50-60Hz (replaces 1414-2)
	Box
	Box Screw (4)
	Cover
	Ground Wire
1210	Float and Valve Assembly
1211	Rubber Plug
	Bracket with (2) Screws (2034)
1215,16,17	Outlet Clamp with (2) Screws and Nuts
1219	Cage
1220	Evaporator Pad
	Closed End
	Open End with Insert (order #1223 Bearing)
	Bearing
	Cage and Pad Assembly
	Pan and Ferrule (for Bleed-Off) Assembly
1225	Retainer
	Front Panel with Window
1230	Mounting Plate
	Overflow Plug
	Bleed-Off Lift Arm
1294	Increaser 6"-7"
1296	Return Air Flange
1297	Damper
1298	Duct Clamp 7" (2)
	Bushing
	Bleed-Off Tube (6 1/2" Vinyl with slits)
	Drum Retainer
2408B	Drain Plug
1094	Plastic Drain Tube 6"
	Tube Clamp (Bleed-Off)
109	Drain Hose Clamp (2)
	Cable Clamp Screw
	Cable Clamp
	Wire Nut (2)
1315	Support Plate for Reduction Gear Box
1311-1	Open end with Brass Insert
1312-2	Closed End with Brass Insert
1514-18	Reduction Gear Box with Fan
1517	Retainer Bearing
1301B	Top with 1313L and 1313R Bracket
1324	Pan
1326A	Front Panel with Window